

AECOM
 AECOM House, 63-77 Victoria Street,
 St. Albans, Hertfordshire, AL1 3ER
 +44(0)1727 535000 tel
 +44(0)1727 535099 fax
 www.aecom.com

1. ALL DIMENSIONS ARE IN METRES UNLESS NOTED OTHERWISE
2. ALL JUNCTION LAYOUTS AREA INDICATIVE
3. DESIGN BASED ON OS MASTERAMP
4. ORDER LIMITS ARE TO THE OUTER EDGE OF THE RED LINE, WHICH IS AS PER PUBLISHED IN THE DCO DOCUMENTATION
5. AS AGREED WITH NATIONAL HIGHWAYS, SUNNICA HGV'S WILL BE PERMITTED TO TURN LEFT IN AND LEFT OUT AT THE A11 / NEWMARKET ROAD JUNCTION.

- KEY
- ORDER LIMITS
 - INDICATIVE JUNCTION LAYOUT

SUMMARY OF USE
 SUNNICA EAST SITE B - SITE ACCESS I
 SECONDARY ACCESS: CONSTRUCTION AND DECOMMISSIONING ONLY.

PEAK NUMBER OF DAILY HGV'S (BETWEEN A11 AND GOLF LINKS ROAD) SITE ACCESS I: 12 HGV'S IN MONTH 2 OF THE CONSTRUCTION PERIOD.

AVERAGE DAILY HGV'S (BETWEEN A11 AND GOLF LINKS ROAD) SITE ACCESS I: 3. DURING THE CONSTRUCTION PERIOD FOR 13 MONTHS.

ISSUE/REVISION

I/R	DATE	DESCRIPTION
C	2022-11-28	MINOR UPDATE DEADLINE 3A
B	2022-11-11	SECOND ISSUE
A	2022-09-23	FIRST ISSUE

KEY PLAN



PROJECT NUMBER

60589004

SHEET TITLE

SUNNICA EAST SITE B,
 SITE ACCESS I (SE-B)
 NEWMARKET ROAD

SHEET NUMBER

ACM-60589004-AMR-DR-0014

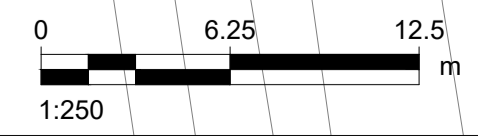

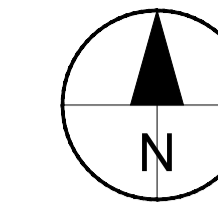

AECOM
AECOM House, 63-77 Victoria Street,
St. Albans, Hertfordshire, AL1 3ER
+44(0)1727 535000 tel
+44(0)1727 535099 fax
www.aecom.com

1. ALL DIMENSIONS ARE IN METRES UNLESS NOTED OTHERWISE
2. ALL JUNCTION LAYOUTS AREA INDICATIVE
3. DESIGN BASED ON OS MASTERAMP
4. ORDER LIMITS ARE TO THE OUTER EDGE OF THE RED LINE, WHICH IS AS PER PUBLISHED IN THE DCO DOCUMENTATION
5. AS AGREED WITH NATIONAL HIGHWAYS, SUNNICA HGV'S WILL BE PERMITTED TO TURN LEFT IN AND LEFT OUT AT THE A11 / NEWMARKET ROAD JUNCTION.
6. NATIONAL HIGHWAY BOUNDARY INFORMATION AVAILABLE AT <https://www.data.gov.uk/dataset/d92af767-a3d8-4860-b7da-d5edf596f90e/highway-boundary>

- █ ORDER LIMITS
- INDICATIVE JUNCTION LAYOUT
- VISIBILITY SPLAY
- HIGHWAY BOUNDARY

SUNNICA EAST SITE B - SITE ACCESS I (SE-I)
SECONDARY ACCESS: CONSTRUCTION AND DECOMMISSIONING ONLY.

PEAK NUMBER OF DAILY HGVS (BETWEEN A11 AND GOLF LINKS ROAD) SITE ACCESS I: 12 HGVS IN MONTH 2 OF THE CONSTRUCTION PERIOD.

AVERAGE DAILY HGVS (BETWEEN A11 AND GOLF LINKS ROAD) SITE ACCESS I: 3. DURING THE CONSTRUCTION PERIOD FOR 13 MONTHS.

I/R	DATE	DESCRIPTION
C	2022-11-28	MINOR UPDATE DEADLINE 3B
B	2022-11-11	SECOND ISSUE
A	2022-09-23	FIRST ISSUE



60589004

SUNNICA EAST SITE B,
SITE ACCESS I (SE-I)
NEWMARKET ROAD

ACM-60589004-AMR-DR-0015

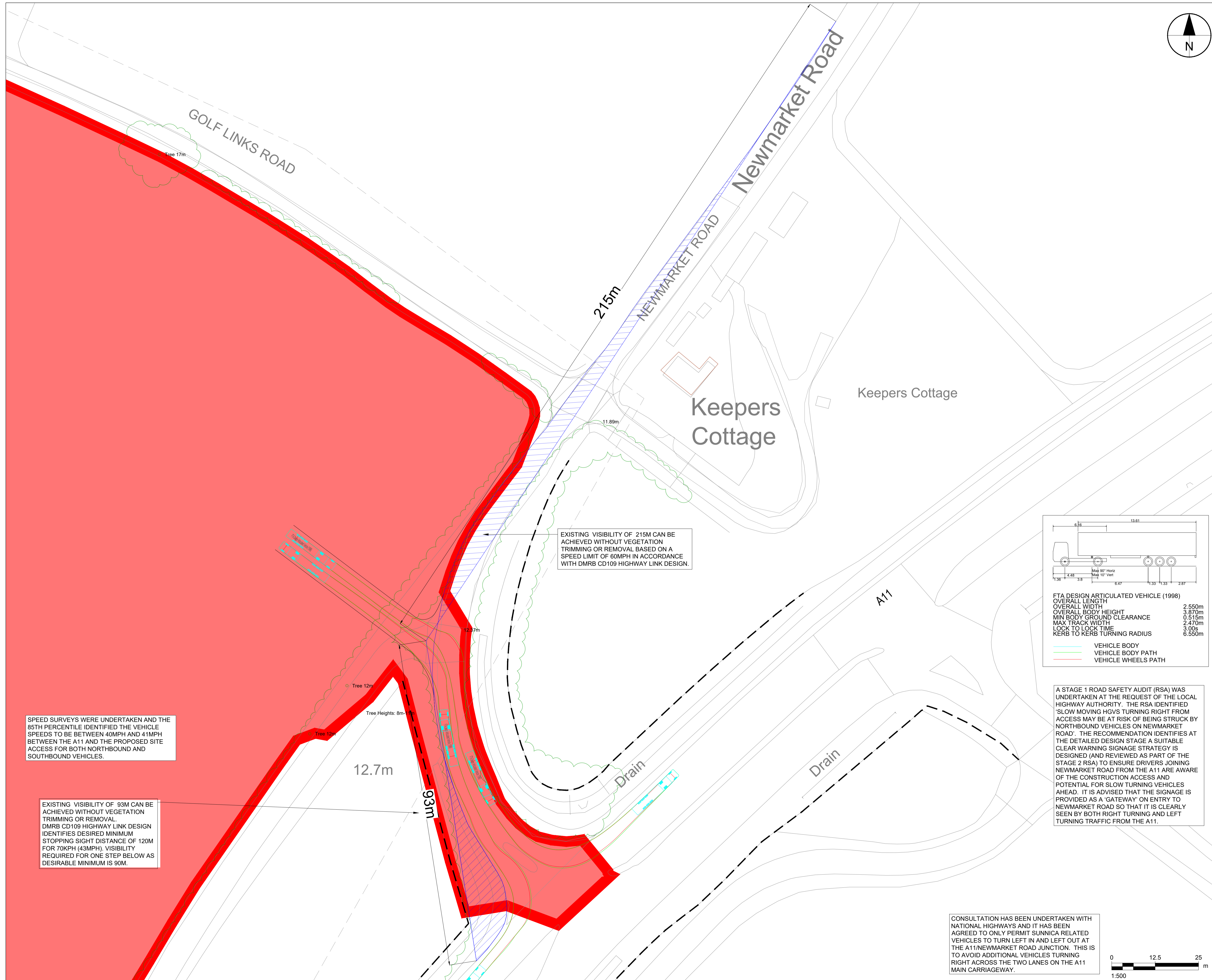

EXISTING VISIBILITY OF 215M CAN BE ACHIEVED WITHOUT VEGETATION TRIMMING OR REMOVAL BASED ON A SPEED LIMIT OF 60MPH IN ACCORDANCE WITH DMRB CD109 HIGHWAY LINK DESIGN.

FTA DESIGN ARTICULATED VEHICLE (1998)

OVERALL LENGTH	13.61m
OVERALL WIDTH	2.550m
OVERALL BODY HEIGHT	3.870m
MIN BODY GROUND CLEARANCE	0.515m
MAX TRACK WIDTH	2.470m
LOCK TO LOCK TIME	3.00s
KERB TO KERB TURNING RADIUS	6.550m

— VEHICLE BODY
— VEHICLE BODY PATH
— VEHICLE WHEELS PATH





A STAGE 1 ROAD SAFETY AUDIT (RSA) WAS UNDERTAKEN AT THE REQUEST OF THE LOCAL HIGHWAY AUTHORITY. THE RSA IDENTIFIED 'SLOW MOVING HGVS TURNING RIGHT FROM ACCESS MAY BE AT RISK OF BEING STRUCK BY NORTHBOUND VEHICLES ON NEWMARKET ROAD'. THE RECOMMENDATION IDENTIFIES AT THE DETAILED DESIGN STAGE A SUITABLE CLEAR WARNING SIGNAGE STRATEGY IS DESIGNED (AND REVIEWED AS PART OF THE STAGE 2 RSA) TO ENSURE DRIVERS JOINING NEWMARKET ROAD FROM THE A11 ARE AWARE OF THE CONSTRUCTION ACCESS AND POTENTIAL FOR SLOW TURNING VEHICLES AHEAD. IT IS ADVISED THAT THE SIGNAGE IS PROVIDED AS A 'GATEWAY' ON ENTRY TO NEWMARKET ROAD SO THAT IT IS CLEARLY SEEN BY BOTH RIGHT TURNING AND LEFT TURNING TRAFFIC FROM THE A11.

CONSULTATION HAS BEEN UNDERTAKEN WITH NATIONAL HIGHWAYS AND IT HAS BEEN AGREED TO ONLY PERMIT SUNNICA RELATED VEHICLES TO TURN LEFT IN AND LEFT OUT AT THE A11/NEWMARKET ROAD JUNCTION. THIS IS TO AVOID ADDITIONAL VEHICLES TURNING RIGHT ACROSS THE TWO LANES ON THE A11 MAIN CARRIAGEWAY.

SPEED SURVEYS WERE UNDERTAKEN AND THE 85TH PERCENTILE IDENTIFIED THE VEHICLE SPEEDS TO BE BETWEEN 40MPH AND 41MPH BETWEEN THE A11 AND THE PROPOSED SITE ACCESS FOR BOTH NORTHBOUND AND SOUTHBOUND VEHICLES.

EXISTING VISIBILITY OF 93M CAN BE ACHIEVED WITHOUT VEGETATION TRIMMING OR REMOVAL. DMRB CD109 HIGHWAY LINK DESIGN IDENTIFIES DESIRED MINIMUM STOPPING SIGHT DISTANCE OF 120M FOR 70KPH (43MPH). VISIBILITY REQUIRED FOR ONE STEP BELOW AS DESIRABLE MINIMUM IS 90M.

ISO A1 594mm x 841mm
 Project Management Initials: Designer: CH
 Checked: CAL
 Approved: CAR
 Filename: E:\PROJECTS\SUNNICA\CAD\ACM-60589004-AMR-DR-0012-13-16.DWG
 Last saved by: HATTONCM
 Last Plotted: 2022-11-28

-  EXISTING ROAD
-  APPROXIMATE OUTER WHEEL TRACK OF TRACTOR UNIT / TRAILER BOGEYS (REFER NOTES)
-  OVERSAIL OF TRAILER GIRDER SECTION
-  PROPOSED SITE ENTRANCE
-  EXISTING TREES / VEGETATION

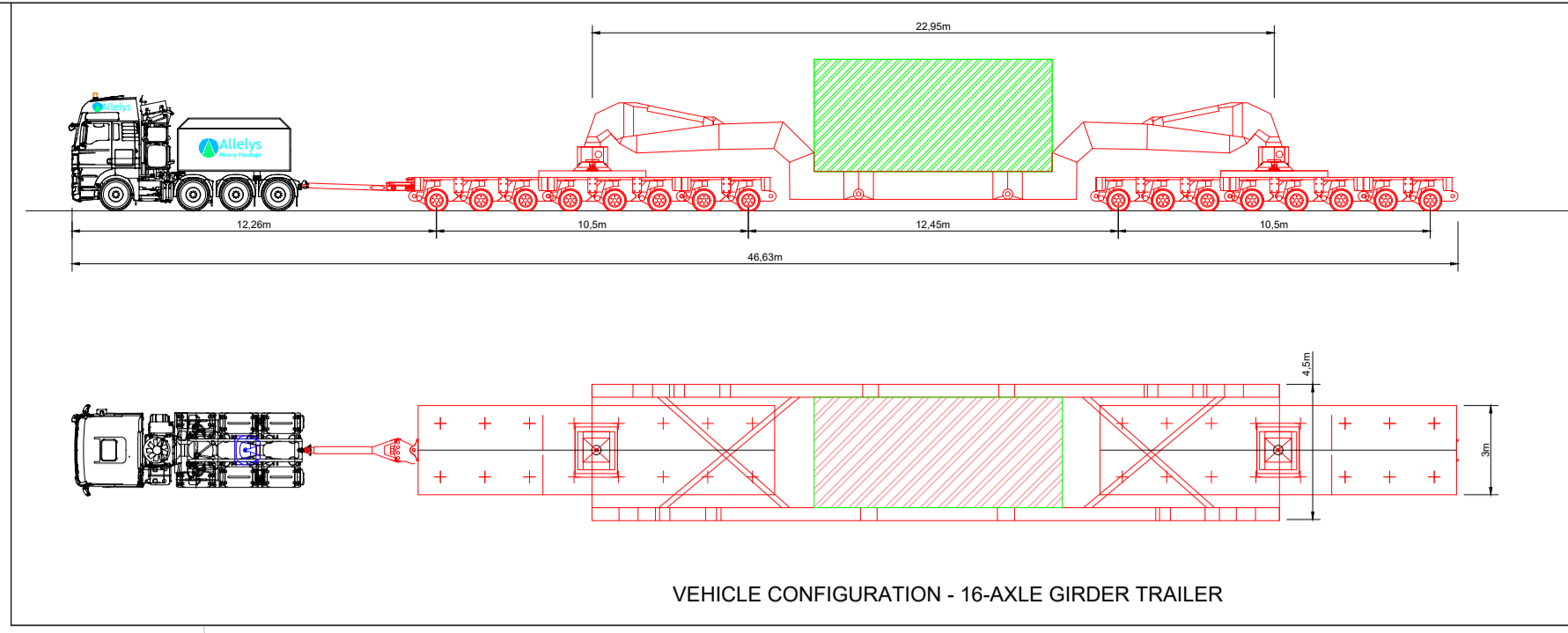

PROJECT



CLIENT

SUNNICA Ltd



CONSULTANT

AECOM
 AECOM House, 63-77 Victoria Street,
 St. Albans, Hertfordshire, AL1 3ER
 +44(0)1727 535000 tel
 +44(0)1727 535099 fax
 www.aecom.com

NOTE

1. ALL DIMENSIONS ARE IN METRES UNLESS NOTED OTHERWISE
2. ALL JUNCTION LAYOUTS AREA INDICATIVE
3. DESIGN BASED ON TOPOGRAPHIC SURVEY UNDERTAKEN BY "ABOVE SURVEYING" IN APRIL 2019.
4. ORDER LIMITS ARE TO THE OUTER EDGE OF THE RED LINE, WHICH IS AS PER PUBLISHED IN THE DCO DOCUMENTATION.
5. ON-SITE MEASUREMENTS RECORDED BY AECOM ON 05/08/2022.

KEY

-  ORDER LIMITS
-  INDICATIVE JUNCTION LAYOUT
-  VEGETATION REMOVAL REQUIRED

SUMMARY OF USE

SUNNICA EAST 2 SITE A - SITE ACCESS K (SE-K)
 SECONDARY ACCESS: CONSTRUCTION, DECOMMISSIONING AND FOR EMERGENCY VEHICLES IN OPERATION ONLY OPERATION ONLY.
 IN USE DURING THE CONSTRUCTION PERIOD FOR 24 MONTHS

SUNNICA EAST SITE A SITE ACCESS K ON BECK ROAD IS PROPOSED TO BE USED BY ABNORMAL INDIVISIBLE LOADS (A/LS) DURING THE CONSTRUCTION PERIOD. THEREFORE, THE A/LS WILL BE ESCORTED UNDER CONTROLLED MEASURES TO THE SITE ACCESS.

ISSUE/REVISION

I/R	DATE	DESCRIPTION
C	2022-11-28	MINOR UPDATE DEADLINE 3A
B	2022-11-11	SECOND ISSUE
A	2022-09-23	FIRST ISSUE

KEY PLAN

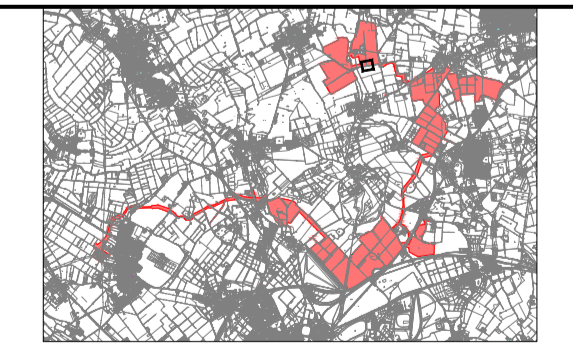

PROJECT NUMBER

60589004

SHEET TITLE

SUNNICA EAST SITE A,
 SITE ACCESS K (SE-K)
 BECK ROAD

SHEET NUMBER

ACM-60589004-AMR-DR-0016

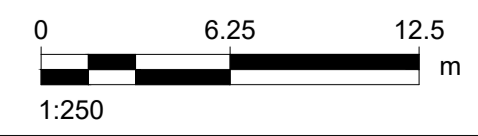
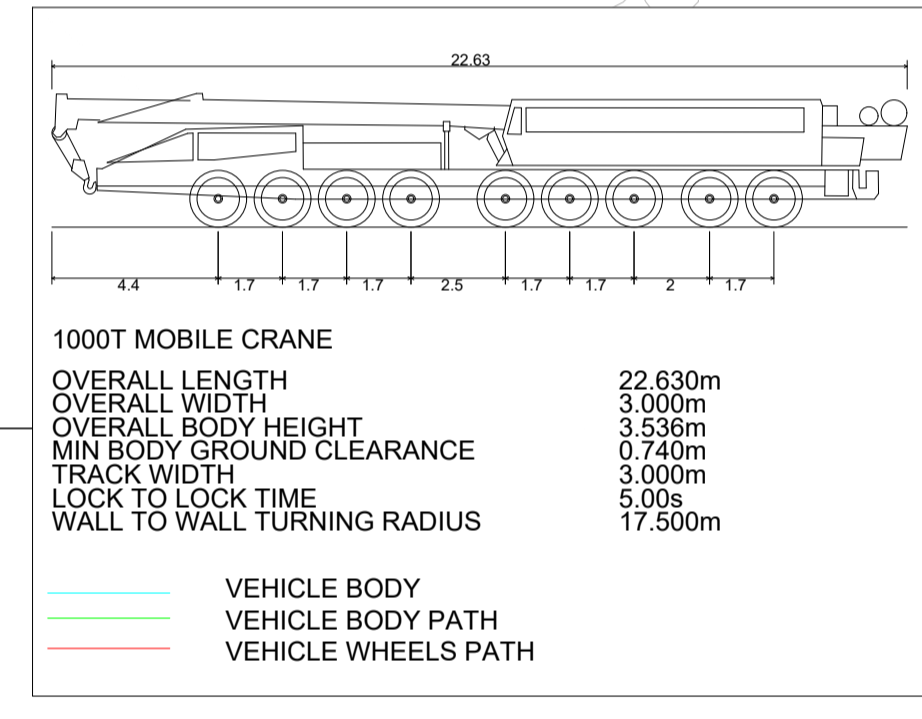
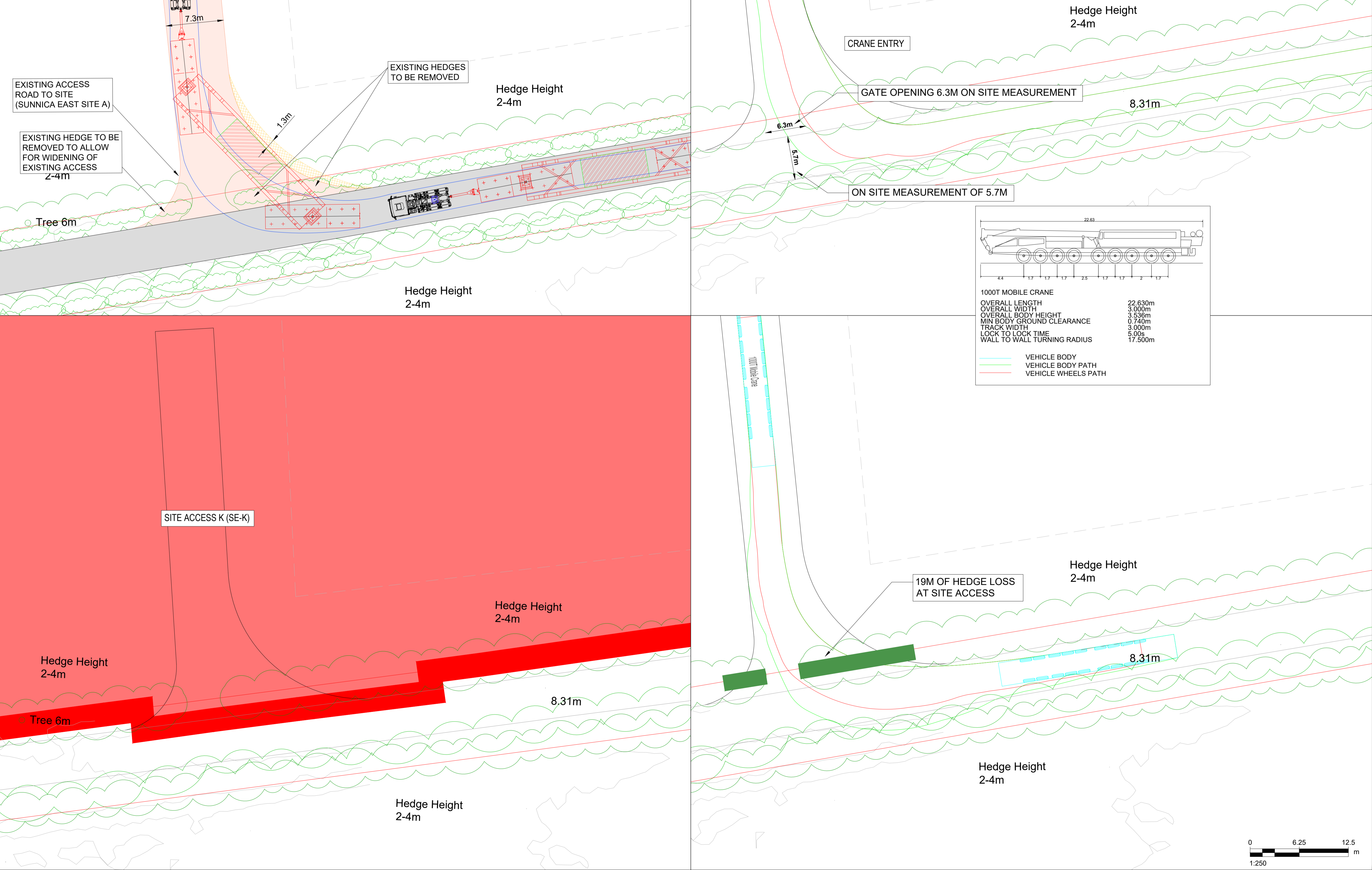

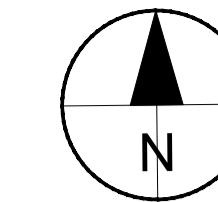

AECOM
AECOM House, 63-77 Victoria Street,
St. Albans, Hertfordshire, AL1 3ER
+44(0)1727 535000 tel
+44(0)1727 535099 fax
www.aecom.com

1. ALL DIMENSIONS ARE IN METRES UNLESS NOTED OTHERWISE
2. ALL JUNCTION LAYOUTS AREA INDICATIVE
3. DESIGN BASED ON TOPOGRAPHIC SURVEY UNDERTAKEN BY "ABOVE SURVEYING" IN APRIL 2019.
4. ORDER LIMITS ARE TO THE OUTER EDGE OF THE RED LINE, WHICH IS AS PER PUBLISHED IN THE DCO DOCUMENTATION

ORDER LIMITS

INDICATIVE JUNCTION LAYOUT

SUNNICA WEST 2 SITE A - SITE ACCESS A
PRIMARY ACCESS: CONSTRUCTION OPERATION AND DECOMMISSIONING.
IN USE DURING THE CONSTRUCTION PERIOD FOR 24 MONTHS.

I/R	DATE	DESCRIPTION
C	2012-02	MINOR UPDATE DEADLINE 3A
B	2022-11-11	SECOND ISSUE
A	2022-09-23	FIRST ISSUE



60589004

SUNNICA WEST SITE A,
SITE ACCESS A (SW-A)
LA HOGUE ROAD (1 OF 3)

ACM-60589004-AMR-DR-0017

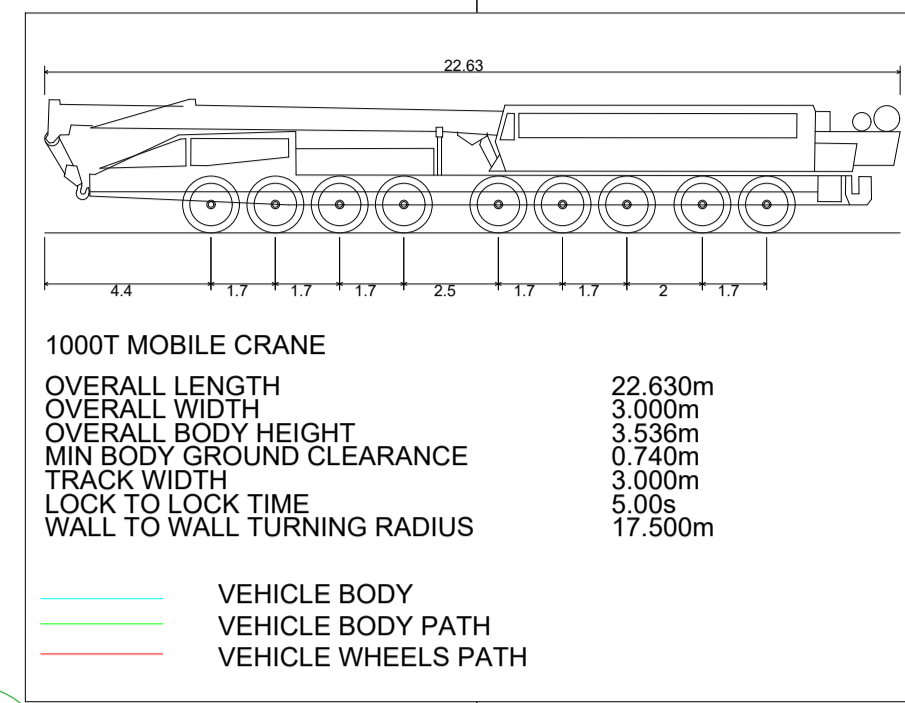

CRANE ENTRY

Hedge Height
2-4m

OVER RUN ON THE
INSIDE FOR LARGE
VEHICLES

CRANE EGRESS

Hedge Height
2-4m

SITE ACCESS A

LA HOGUE ROAD

Hedge Height
2-4m

25.41m

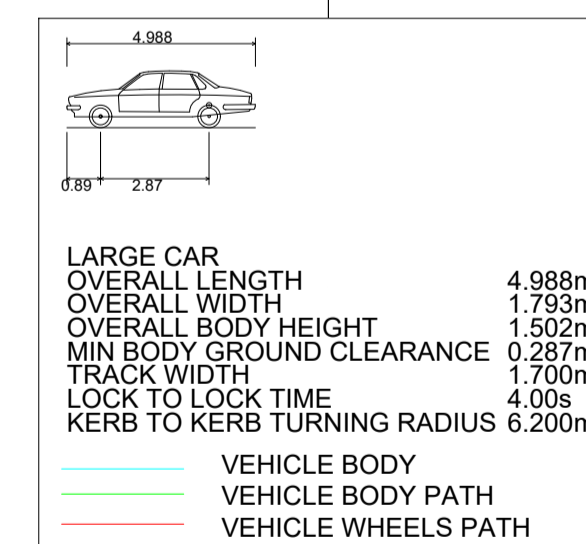

LARGE CAR LEFT &
RIGHT TURN ENTRY

Hedge Height
2-4m

LARGE CAR LEFT &
RIGHT TURN EGRESS

Hedge Height
2-4m

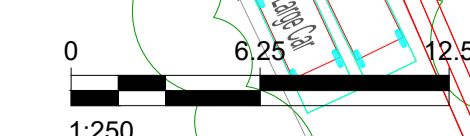

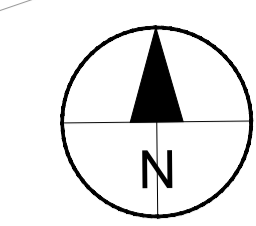
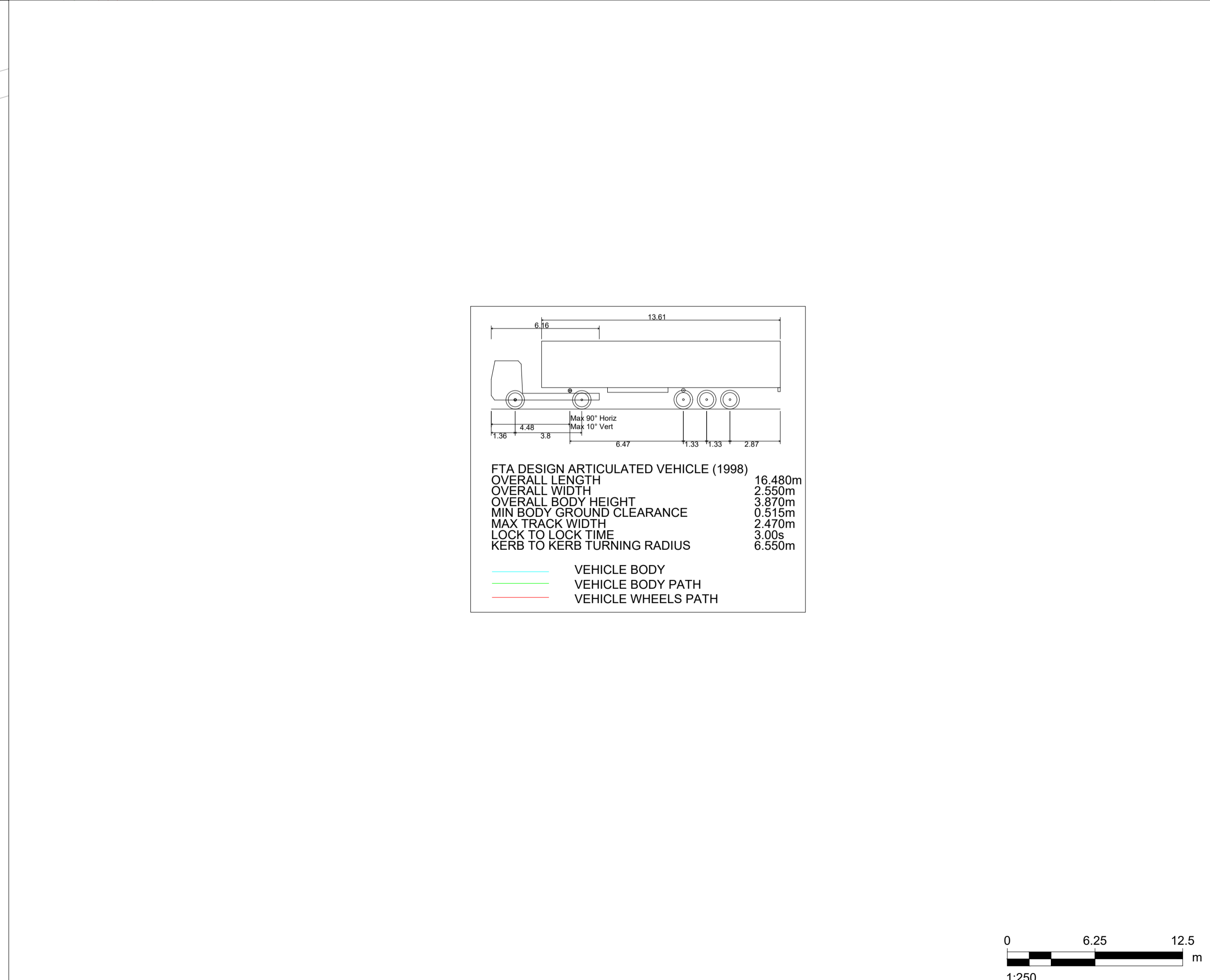
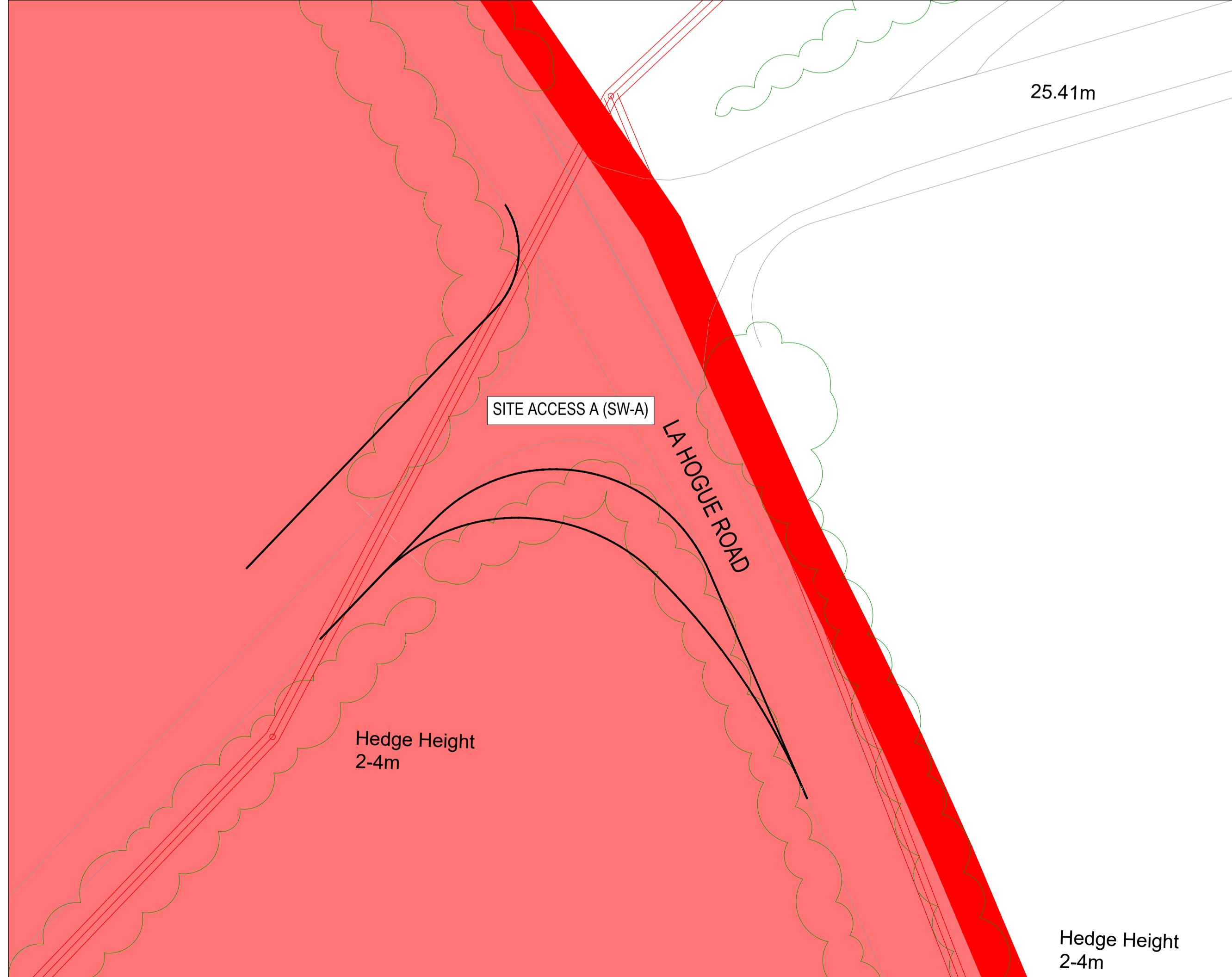
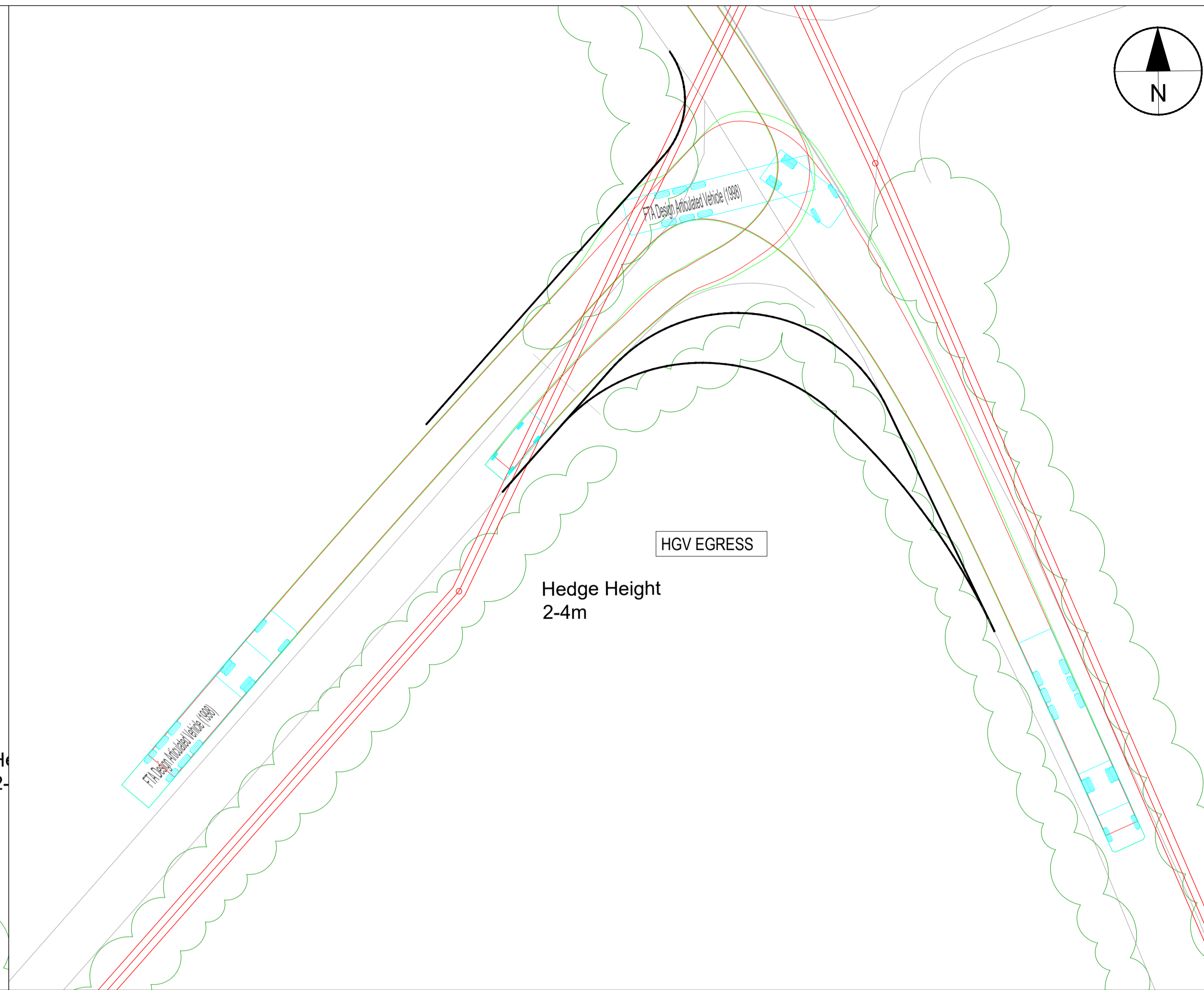
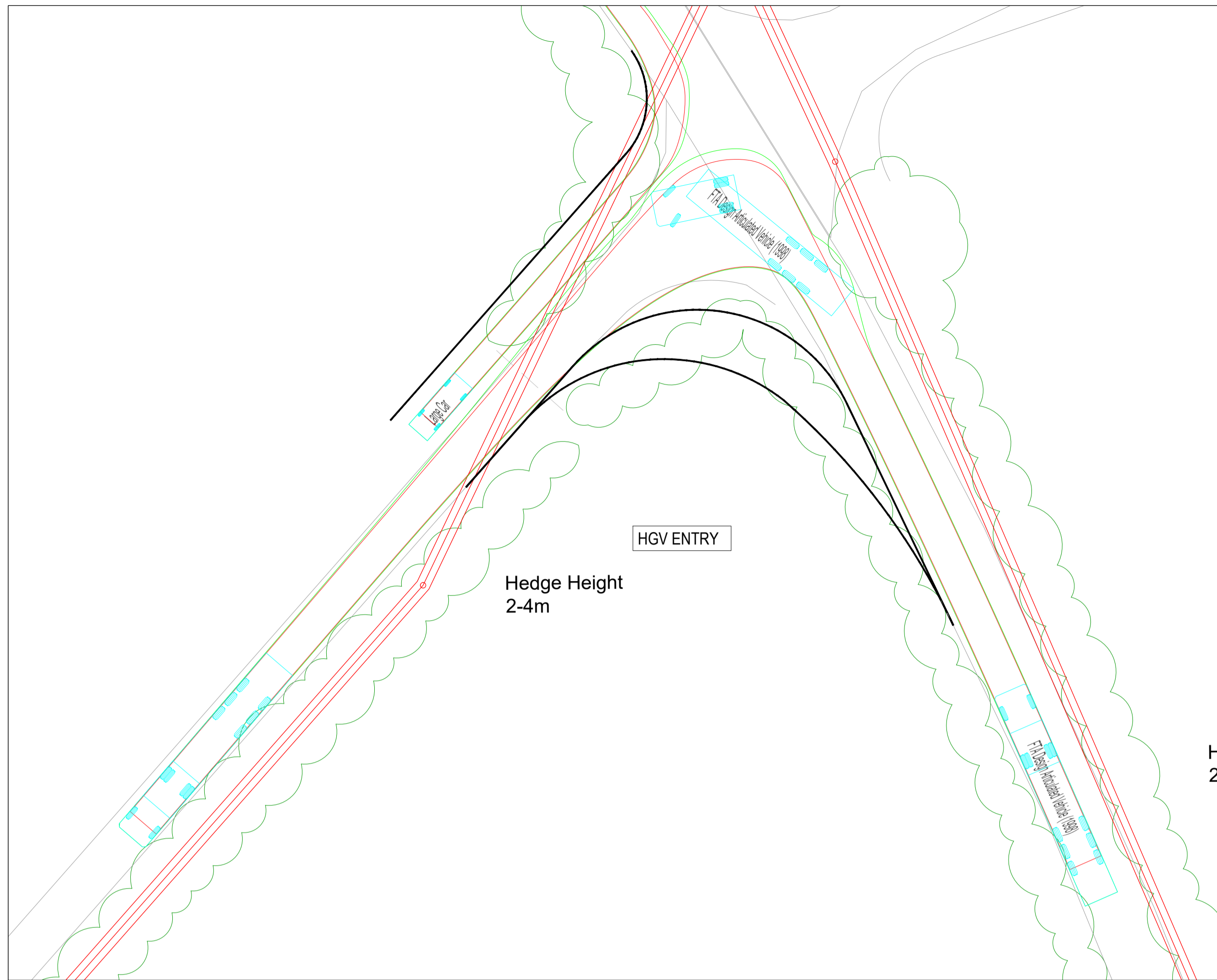

ISSUE/REVISION

I/R	DATE	DESCRIPTION
C	2022-11-28	MINOR UPDATE DEADLINE 3A
B	2022-11-11	SECOND ISSUE
A	2022-09-23	FIRST ISSUE

KEY PLAN



PROJECT NUMBER

60589004

SHEET TITLE

SUNNICA WEST SITE A,
 SITE ACCESS A (SW-A)
 LA HOGUE ROAD (2 OF 3)

SHEET NUMBER

ACM-60589004-AMR-DR-0018

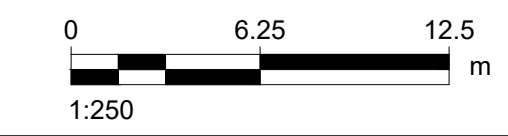

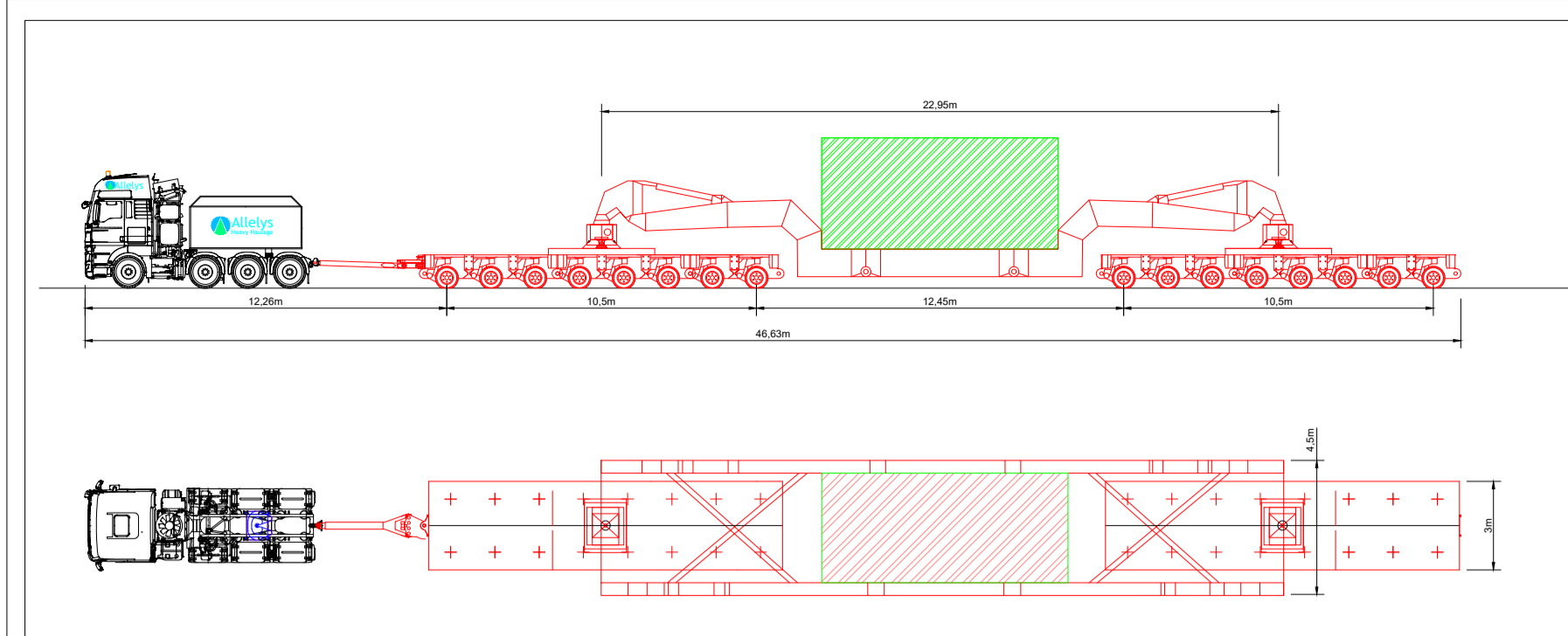

- APPROXIMATE OUTER WHEEL TRACK OF TRACTOR UNIT / TRAILER BOGEYS (REFER NOTES)
- OVERSAIL OF TRAILER GIRDER SECTION
- PROPOSED SITE ENTRANCE
- EXISTING TREES / VEGETATION

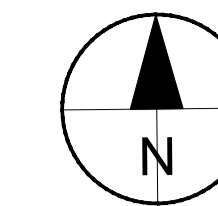
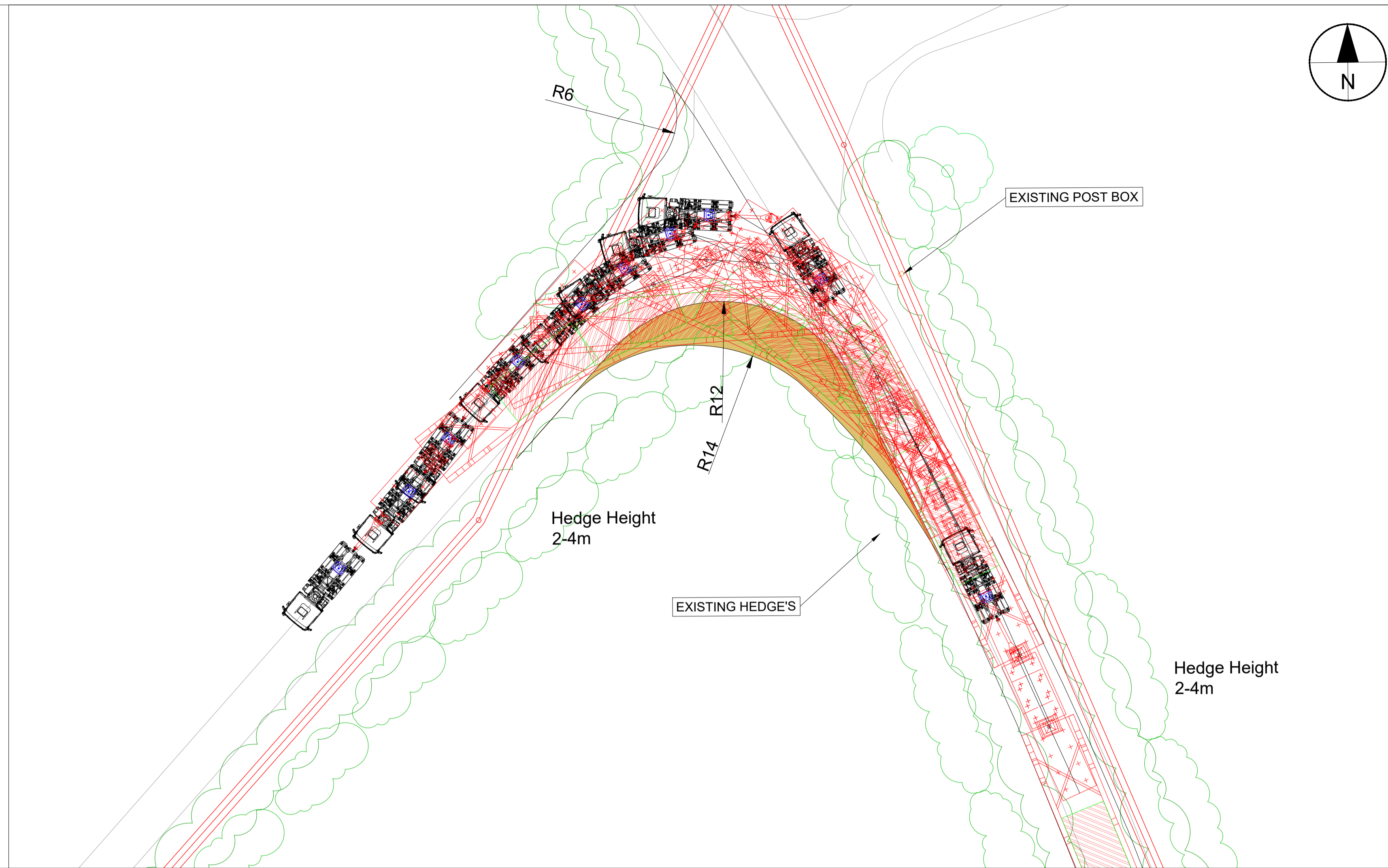

AECOM
 AECOM House, 63-77 Victoria Street,
 St. Albans, Hertfordshire, AL1 3ER
 +44(0)1727 535000 tel
 +44(0)1727 535099 fax
 www.aecom.com

NOTE

1. ALL DIMENSIONS ARE IN METRES UNLESS NOTED OTHERWISE
2. ALL JUNCTION LAYOUTS AREA INDICATIVE
3. DESIGN BASED ON TOPOGRAPHIC SURVEY UNDERTAKEN BY "ABOVE SURVEYING" IN APRIL 2019.
4. ORDER LIMITS ARE TO THE OUTER EDGE OF THE RED LINE, WHICH IS AS PER PUBLISHED IN THE DCO DOCUMENTATION

KEY

- ORDER LIMITS
- LARGE VEHICLE OVER-RUN AREA
- INDICATIVE JUNCTION LAYOUT

SUMMARY OF USE

SUNNICA WEST SITE A - SITE ACCESS A
 PRIMARY ACCESS: CONSTRUCTION OPERATION AND DECOMMISSIONING.
 IN USE DURING THE CONSTRUCTION PERIOD FOR 24 MONTHS

ISSUE/REVISION

I/R	DATE	DESCRIPTION
C	2022-11-28	MINOR UPDATE DEADLINE 3A
B	2022-11-11	SECOND ISSUE
A	2022-09-23	FIRST ISSUE

KEY PLAN



PROJECT NUMBER

60589004

SHEET TITLE

SUNNICA WEST SITE A,
 SITE ACCESS A, (SW-A)
 LA HOGUE ROAD (3 OF 3)

SHEET NUMBER

ACM-60589004-AMR-DR-0019

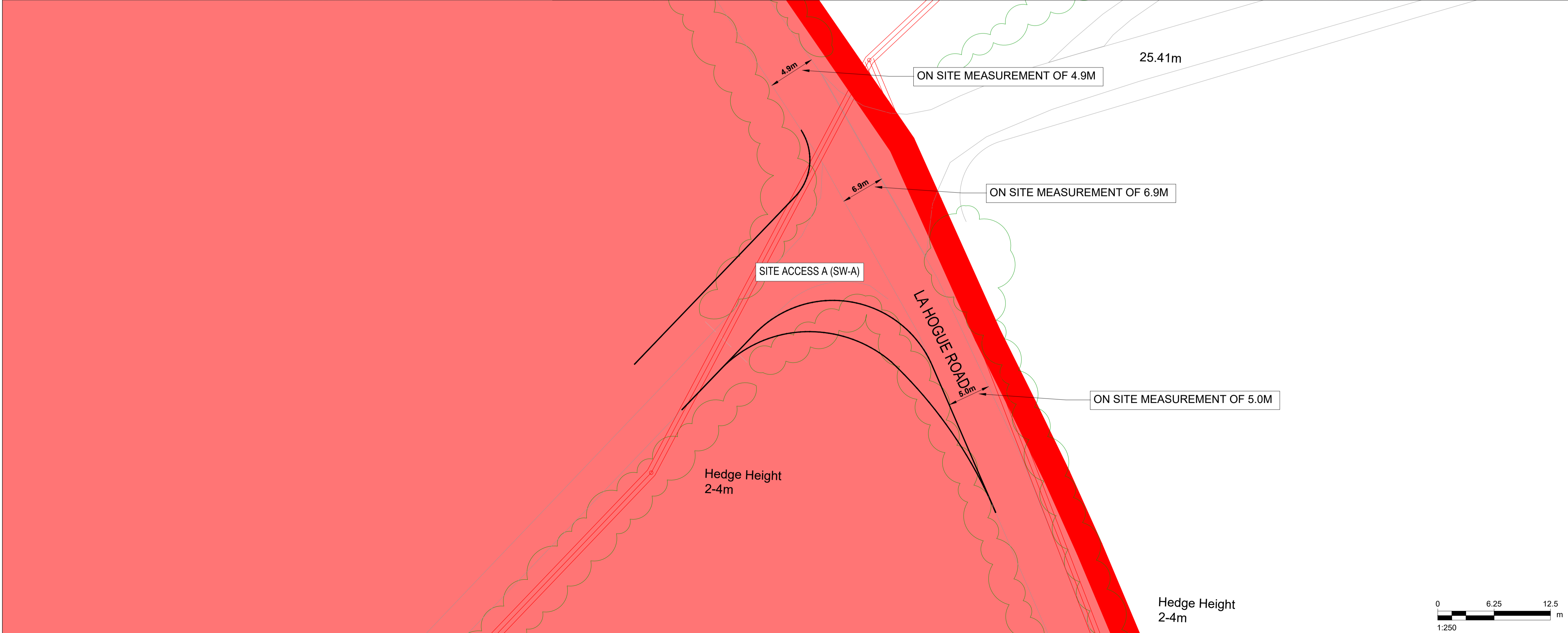

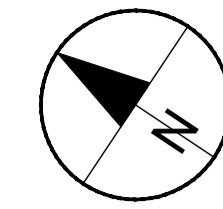

AECOM
AECOM House, 63-77 Victoria Street,
St. Albans, Hertfordshire, AL1 3ER
+44(0)1727 535000 tel
+44(0)1727 535099 fax
www.aecom.com

1. ALL DIMENSIONS ARE IN METRES UNLESS NOTED OTHERWISE
2. ALL JUNCTION LAYOUTS AREA INDICATIVE DESIGN BASED ON OS AND LAND REGISTRY DATA
3. ORDER LIMITS ARE TO THE OUTER EDGE OF THE RED LINE, WHICH IS AS PER PUBLISHED IN THE DCO DOCUMENTATION

- ORDER LIMITS
- PASSING PLACE
- OS LINES
- SOUTHBOUND HGV TRAVEL WITH WING MIRROR CLEARANCE (GREEN LINE VEHICLE BODY, BLUE LINE WING MIRRORS)
- SITE ACCESS JUNCTION
- FORWARD LINE OF VISIBILITY

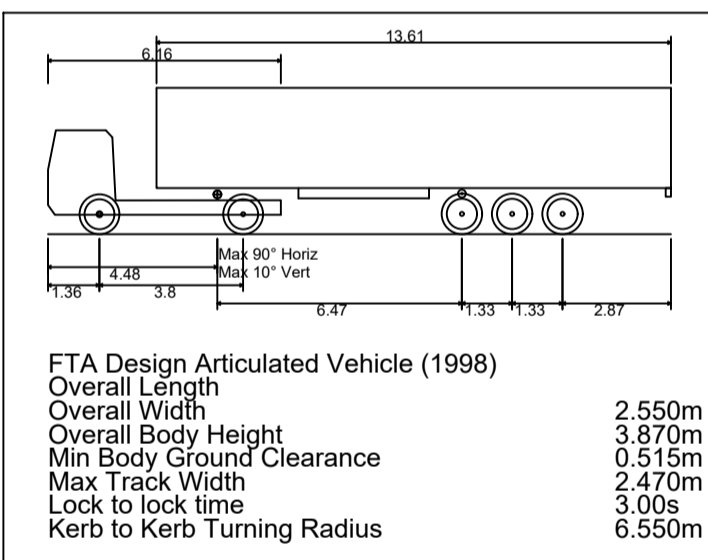

I/R	DATE	DESCRIPTION
B	2022-11-11	SECOND ISSUE
A	2022-09-30	FIRST ISSUE

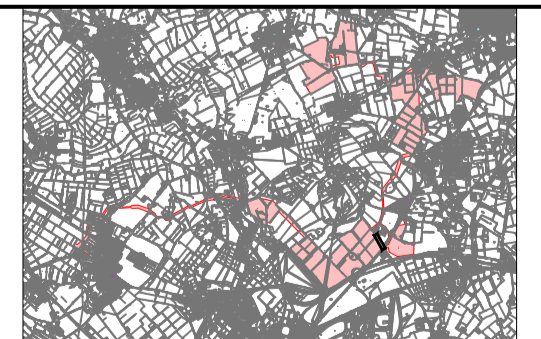

60589004

SUNNICA EAST SITE B,
LA HOGUE ROAD, PASSING BAYS
2 WAY HGV

ACM-60589004-AMR-DR-0020

